

OVERLAY IDENTIFICATION
 PROJ. NO. C-1A
 OVERLAY NO. 1
 CONTRACT NO. S

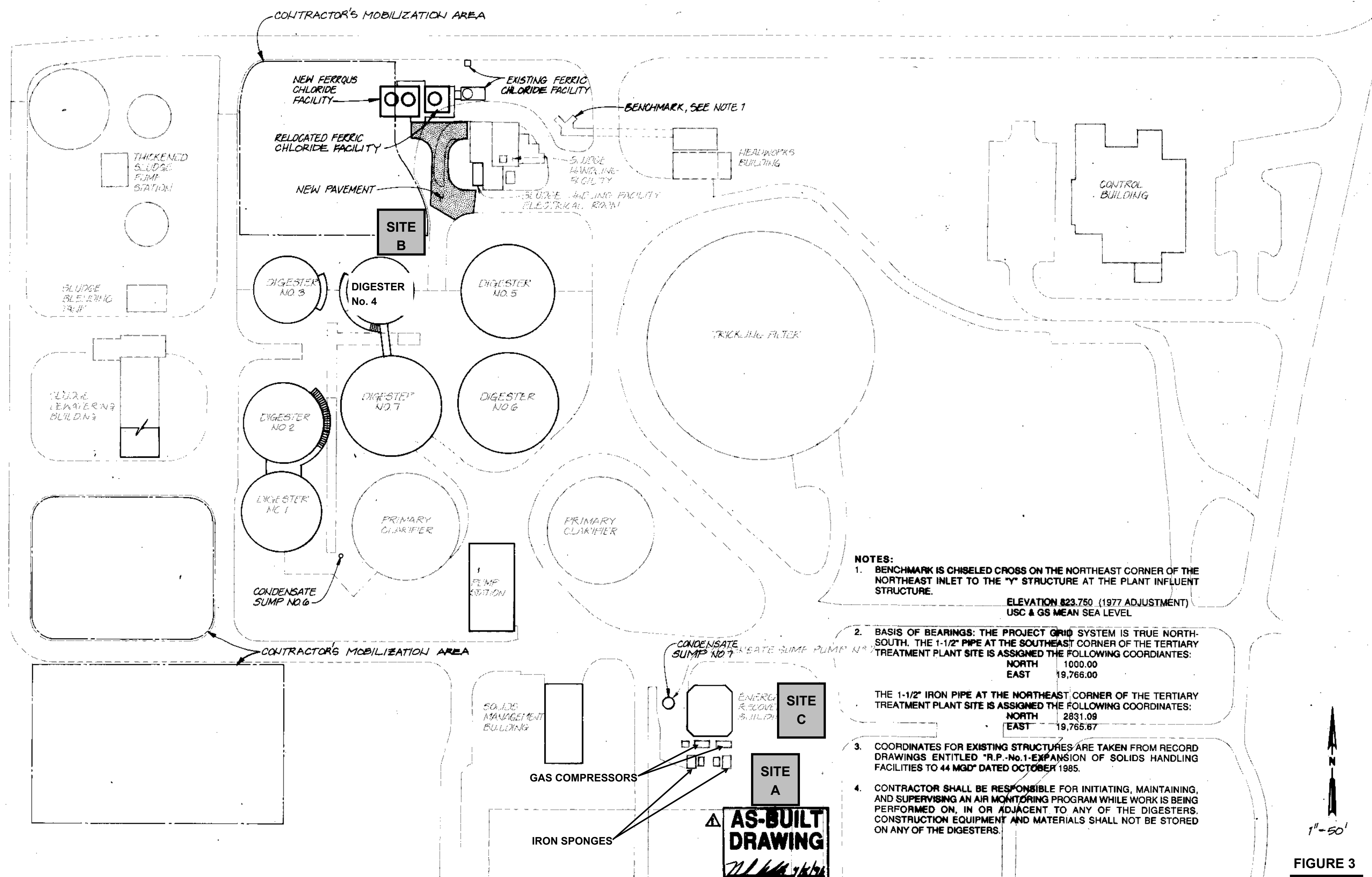

- NOTES:**
- BENCHMARK IS CHISELED CROSS ON THE NORTHEAST CORNER OF THE NORTHEAST INLET TO THE "Y" STRUCTURE AT THE PLANT INFLUENT STRUCTURE.
 ELEVATION 823.750 (1977 ADJUSTMENT)
 USC & GS MEAN SEA LEVEL
 - BASIS OF BEARINGS: THE PROJECT GRID SYSTEM IS TRUE NORTH-SOUTH. THE 1-1/2" PIPE AT THE SOUTHEAST CORNER OF THE TERTIARY TREATMENT PLANT SITE IS ASSIGNED THE FOLLOWING COORDINATES:
 NORTH 1000.00
 EAST 19,766.00
 THE 1-1/2" IRON PIPE AT THE NORTHEAST CORNER OF THE TERTIARY TREATMENT PLANT SITE IS ASSIGNED THE FOLLOWING COORDINATES:
 NORTH 2831.09
 EAST 19,765.67
 - COORDINATES FOR EXISTING STRUCTURES ARE TAKEN FROM RECORD DRAWINGS ENTITLED "R.P.-No.1-EXPANSION OF SOLIDS HANDLING FACILITIES TO 44 MGD" DATED OCTOBER 1985.
 - CONTRACTOR SHALL BE RESPONSIBLE FOR INITIATING, MAINTAINING, AND SUPERVISING AN AIR MONITORING PROGRAM WHILE WORK IS BEING PERFORMED ON, IN OR ADJACENT TO ANY OF THE DIGESTERS. CONSTRUCTION EQUIPMENT AND MATERIALS SHALL NOT BE STORED ON ANY OF THE DIGESTERS.

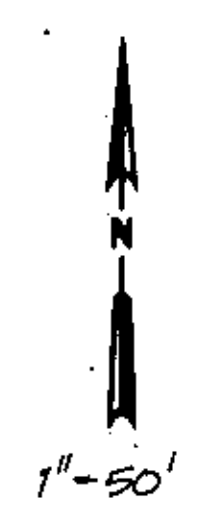

FIGURE 3



DSGN LV MISSLIN	NO. DATE	AS-BUILT DWG. PER CONTRACTOR SUBMITTAL	T.W.	BY APVD
DR J. CHELONIS				
CHK M. DAMOTH				
APVD J. NEWTON				

APPROVED	R.E. No.	Date
General Manager		
APPROVED	R.E. No.	Date
<i>W. H. ...</i>		

BAR IS ONE INCH ON ORIGINAL DRAWING.
 IF NOT ONE INCH ON THIS SHEET, ADJUST SCALES ACCORDINGLY.

CHINO BASIN MUNICIPAL WATER DISTRICT
 8888 Archibald Avenue
 Cucamonga, California 91730
 Post Office Box 987
 Telephone (714) 987-1712

DIGESTER GAS SYSTEM IMPROVEMENTS.
 REGIONAL PLANT No. 1
OVERALL SITE PLAN
 WITH POTENTIAL SITES FOR BIOGAS PILOT EQUIPMENT

SHEET 6
DWG NO. C-1
DATE AUG 1992
PROJ NO. LAQ27836.B1

D6467-6